

FWA-7304G

User Manual

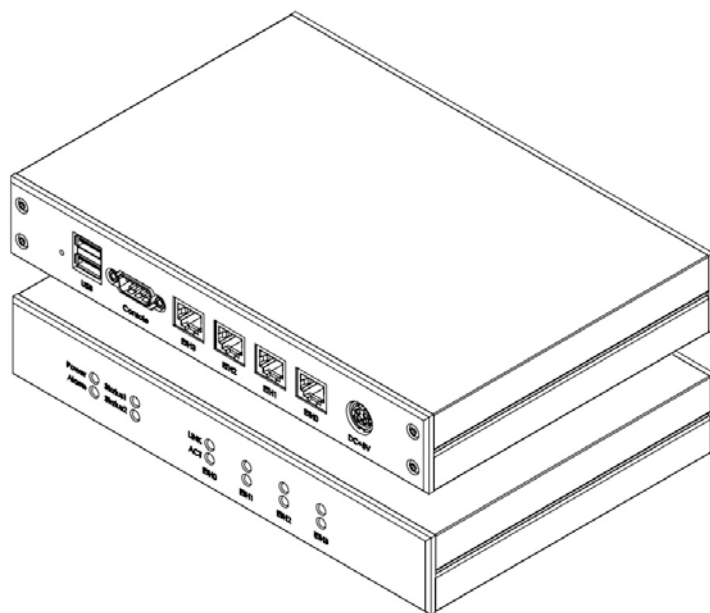

2009 December V1.0

Copyright © 2009 IBASE Technology INC. All Rights Reserved.

No part of this manual, including the products and software described in it, may be reproduced, transmitted, transcribed, stored in a retrieval system, or translated into any language in any form or by any means, except documentation kept by the purchaser for backup purposes, without the express written permission of IBASE Technology INC. ("IBASE").

Products and corporate names mentioned in this manual may or may not be registered trademarks or copyrights of their respective companies, and are used for identification purposes only. All trademarks are the property of their respective owners.

Every effort has been made to ensure that the contents of this manual are correct and up to date. However, the manufacturer makes no guarantee regarding the accuracy of its contents, and reserves the right to make changes without prior notice.

Table of Contents

<i>Accessories</i>	6
<i>Components</i>	7
Front View	7
Rear View	8
<i>Specification</i>	9
<i>Exploded view of the FWA-7304G assembly</i>	10
Parts description	10
<i>Driver Installation</i>	11
<i>BIOS Setup</i>	11

Safety Information

Your FWA-7304G is designed and tested to meet the latest standards of safety for information technology equipment. However, to ensure your safety, it is important that you read the following safety instructions.

Setting up your system

- Read and follow all instructions in the documentation before you operate your system.
- Do not use this product near water.
- Set up the system on a stable surface or secure on wall with the provided rail. Do not secure the system on any unstable plane or without the rail.
- Do not place this product on an unstable cart, stand, or table. The product may fall, causing serious damage to the product.
- Slots and openings on the chassis are for ventilation. Do not block or cover these openings. Make sure you leave plenty of space around the system for ventilation. Never insert objects of any kind into the ventilation openings.
- This system should be operated from the type of power indicated on the marking label. If you are not sure of the type of power available, consult your dealer or local power company.
- Use this product in environments with ambient temperatures between 0°C and 45°C.
- If you use an extension cord, make sure that the total ampere rating of the devices plugged into the extension cord does not exceed its ampere rating.

Care during use

- Do not walk on the power cord or allow anything to rest on it.
- Do not spill water or any other liquids on your system.
- When the system is turned off, a small amount of electrical current still flows. Always unplug all power, and network cables from the power outlets before cleaning the system.
- If you encounter the following technical problems with the product, unplug the power cord and contact a qualified service technician or your retailer.
 - The power cord or plug is damaged.
 - Liquid has been spilled into the system.
 - The system does not function properly even if you follow the operating instructions.

- The system was dropped or the cabinet is damaged.

Lithium-Ion Battery Warning

CAUTION: Danger of explosion if battery is incorrectly replaced. Replace only with the same or equivalent type recommended by the manufacturer. Dispose of used batteries according to the manufacturer's instructions.

NO DISASSEMBLY

The warranty does not apply to the products that have been disassembled by users

Accessories

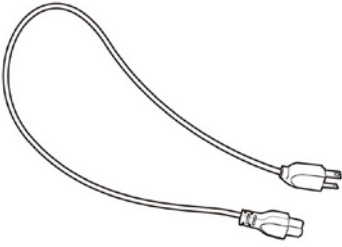
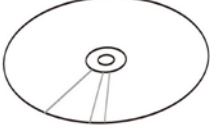
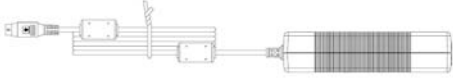
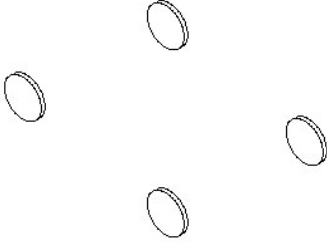
	
a. Power Cord x 1	b. Driver & M/B Manual CD x 1
	
c. Power Adapter x 1	d. Rubber Foot x 4

Components

Front View

Refer to the diagram below to identify the components on this side of the system.

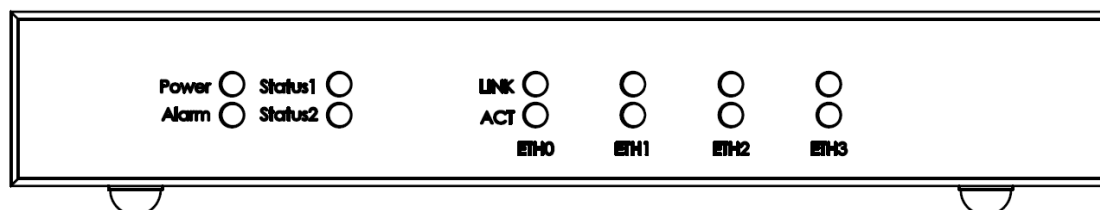

Power

The power LED illuminated when system been power on.

Alarm

There are user programmable indicators. Each indicator can be program to specify status indicator. The detail programming method please refer M/B user manual.

Status1 & Status2

There are user programmable indicators. Each indicator can be program to specify status indicator. The detail programming method please refer M/B user manual.

LINK

The orange color shows corresponding LAN port connected with Giga-speed.
The Green color shows corresponding LAN port connected with 100-Base-T speed.

ACT

The LED illuminated when corresponding LAN port transmitted or received data.

ETH0~ETH3

Corresponding to each LAN port status indicators.

Rear View

Refer to the diagram below to identify the components on this side of the system.

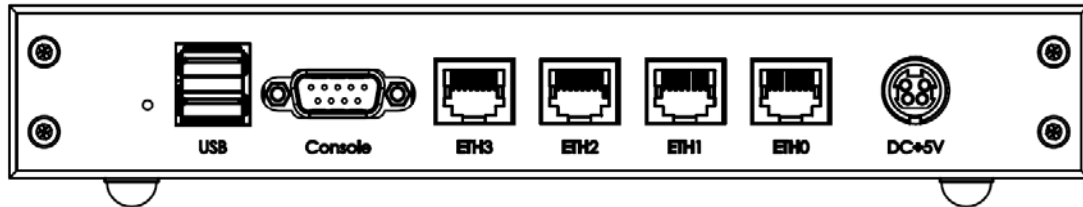

DC+5V

The supplied power adapter converts AC power to DC power for use with this jack. Power supplied through this jack supplies power to the system. To prevent damage to the system, always use the supplied power adapter.

ETH0~ETH3

The eight-pin RJ-45 LAN port supports a standard Ethernet cable for connection to a local network up to Giga-bit transfer rate.

USB

The USB (Universal Serial Bus) port is compatible with USB devices such as keyboards, mouse devices, cameras, and hard disk drives. USB allows many devices to run simultaneously on a single computer, with some peripheral acting as additional plug-in sites or hubs.

Console

There is standard RS232 serial port present by RJ45 connector format. The detail usage please refers to M/B user manual.

Specification

System Mainboard	IB792F
Construction	Aluminum
Chassis Color	Gray
Storage	2.5" SATA HDD x 1(Optional)
Mounting	Desktop
Dimensions	225(W) x 35.8 (H) x 156(D)mm / (8.65" x 1.4" x 6.14")
Power Supply	25W power adapter
Operating Temperature	0°C ~ 45°C (32°F ~ 113°F) still air
Storage Temperature	-20°C ~ 70°C
Relative Humidity	5~95% @45°C (non-condensing)
Vibration	HDD: 0.25g/5~500Hz random operation
Shock	HDD: 15g peak acceleration (11 msec duration)
RoHS	Available

· This specification is subject to change without prior notice.

Exploded view of the FWA-7304G assembly

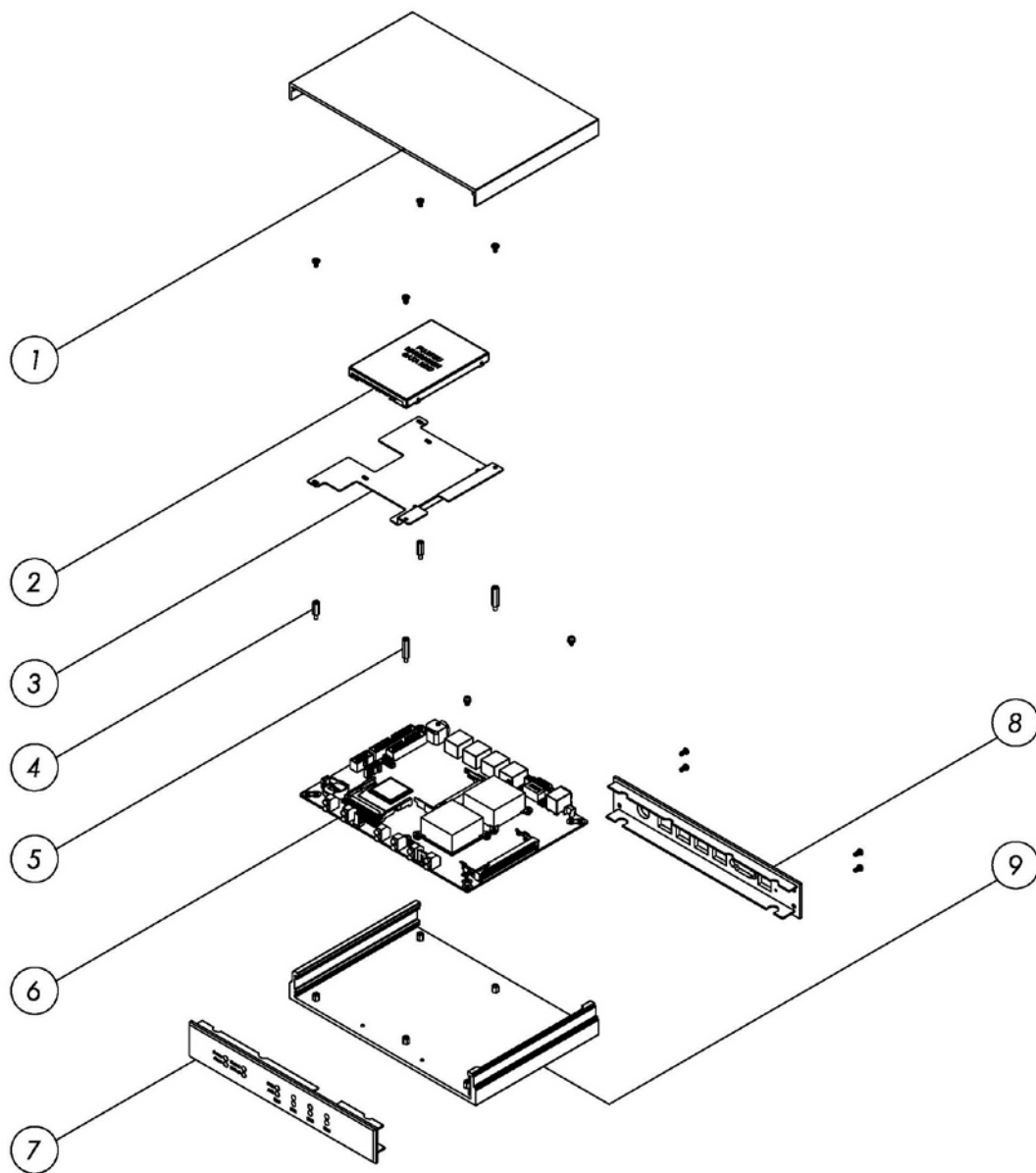

Parts description

Part NO.	Description	Part NO.	Description
1	Top Cover	2	2.5" SATA HDD
3	HDD Bracket	4	HDD Bracket Boss Lower
5	HDD Bracket Boss	6	IB792F
7	Front Plate	8	Rear Plate
9	Base Chassis		

Driver Installation

Please refer correspond mainboard user manual to install the driver properly.

BIOS Setup

Please refer correspond mainboard user manual to configure BIOS setting.